

Tin-plated brass clamp

- Tinned brass turned earth terminals, M6 thread.

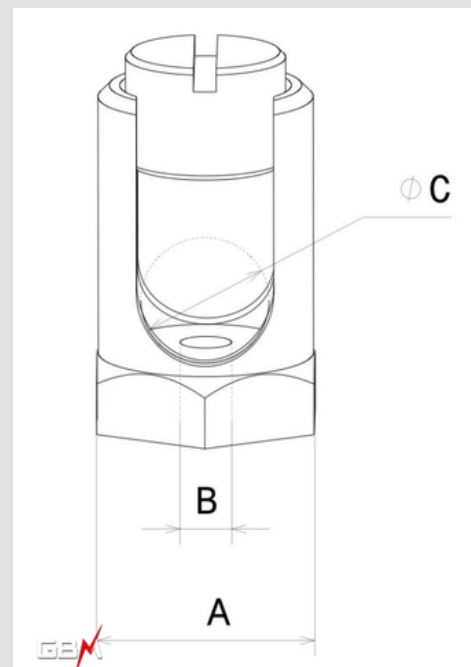

Reference	ØC Conductors Capacity (mm)	A (mm)	B (mm)	Weight/100 (Kg)	Packaging (Pces)
BLE25-6	3-6 mm	17	M6	2.40	50
BLE35-6	4-8 mm	18	M6	3.10	50
BLE50-6	7-10 mm	21	M6	4.65	50
BLE95-6	8-12 mm	24	M6	6.71	25
BLE120-6	10-14 mm	26	M6	8.80	25

* Other threads possible on request